



# West Lancashire Borough Council Licensing Service

Application for a premises licence to be granted under the  
Licensing Act 2003

Robert Hodge Centre  
Stanley Way  
Skelmersdale  
Lancashire  
WN8 8EE  
Tel: 01695 577177  
Fax: 01695 585126  
Email: [licensing.enquiries@westlancs.gov.uk](mailto:licensing.enquiries@westlancs.gov.uk)  
Website: [www.westlancs.gov.uk/licensing](http://www.westlancs.gov.uk/licensing)

## Application for a premises licence to be granted under the Licensing Act 2003

### PLEASE READ THE FOLLOWING INSTRUCTIONS FIRST

Before completing this form please read the guidance notes at the end of the form.

If you are completing this form by hand please write legibly in block capitals. In all cases ensure that your answers are inside the boxes and written in black ink. Use additional sheets if necessary.

You may wish to keep a copy of the completed form for your records.

I/We ORMSKIRK PUBCO LIMITED apply for a premises licence under section 17 of the Licensing Act 2003 for the premises described in Part 1 below (the premises) and I/we are making this application to you as the relevant licensing authority in accordance with section 12 of the Licensing Act 2003

### Part 1 – Premises Details

<b>Postal address of premises or, if none, ordnance survey map reference or description</b>	
188 MOSS LANE BURSCOUGH	
<b>Post town</b> Ormskirk	<b>Post code</b> L40 4AY

Telephone number at premises (if any)

Non-domestic rateable value of premises

£ 25,750.00

### Part 2 – Applicant details

Please state whether you are applying for a premises licence as

	Please tick ✓ (yes)
a) An individual or individuals*	<input type="checkbox"/> Please complete section (A)
b) A person other than an individual*	<input type="checkbox"/> Please complete section (B)
i. as a limited company	<input checked="" type="checkbox"/> Please complete section (B)
ii. as a partnership	<input type="checkbox"/> Please complete section (B)
iii. as an unincorporated association or	<input type="checkbox"/> Please complete section (B)
iv. other (for example a statutory corporation)	<input type="checkbox"/> Please complete section (B)
c) A recognised club	<input type="checkbox"/> Please complete section (B)
d) A charity	<input type="checkbox"/> Please complete section (B)
e) The proprietor of an educational establishment	<input type="checkbox"/> Please complete section (B)
f) A health service body	<input type="checkbox"/> Please complete section (B)
g) A person who is registered under Part 2 of the Care Standards Act 2000 (c14) in respect of an independent hospital	<input type="checkbox"/> Please complete section (B)

ga) A person who is registered under Chapter 2 of Part 1 of the Health and Social Care Act 2008 in respect of the carrying on of a regulated activity (within the meaning of that part) in an independent hospital in England ☐ Please complete section (B)

h) The chief officer of police of a police force in England and Wales ☐ Please complete section (B)

\*If you are applying as a person described in (a) or (b) please confirm:

Please tick ✓ (yes)

a) I am carrying on or proposing to carry on a business which involves the use of the premises for licensable activities; or ☐

b) I am making the application pursuant to a  
- statutory function or ☐  
- a function discharged by virtue of Her Majesty's prerogative ☐

**(A) INDIVIDUAL APPLICANTS** (fill in as applicable)

Mr ☐ Mrs ☐ Miss ☐ Ms ☐ Other ☐  
(for example, Rev)

Surname

First Names

Please tick ✓ Yes

I am 18 years old or over

☐

Current postal address if different from premises address

Post Town

Postcode

Daytime contact telephone number

E-mail address (optional)

This section is intentionally blank

**SECOND INDIVIDUAL APPLICANT (IF APPLICABLE)**

Mr ☐ Mrs ☐ Miss ☐ Ms ☐ Other ☐  
(for example, Rev)

Surname

First Names

Please tick ✓ Yes

I am 18 years old or over

☐

Current postal  
address if different from  
premises address

Post Town

Postcode

Daytime contact telephone number

E-mail address  
(optional)

E-mail address  
(optional)

This section is intentionally blank

## (B) OTHER APPLICANTS

Please provide name and registered address of applicant in full. Where appropriate please give any registered number. In case of a partnership or other joint nature (other than a body corporate), please give the name and address of each party concerned.

Name ORMSKIRK PUBCO LIMITED
Address 105 GARSTANG ROAD PRESTON PR1 1LD
Registered Number (where applicable) 10440002
Description of applicant (for example, partnership, company, unincorporated association etc.) Limited Company
Telephone number (if any)
E-mail address (optional)

### Part 3 Operating Schedule

When do you want the premises licence to start?

Day	Month	Year
<input type="text"/>	<input type="text"/>	<input type="text"/>

If you wish the licence to be valid only for a limited period, when do you want it to end?

Day	Month	Year
<input type="text"/>	<input type="text"/>	<input type="text"/>

If 5,000 or more people are expected to attend the premises at any one time, please state the number expected to attend.

Please give a general description of the premises (please read guidance note 1)

**Restaurant, café and bar offering substantial hot food and occasional regulated entertainment on Ground Floor of premises with facilities area in accordance with the plans attached and accompanying the application**

**What licensable activities do you intend to carry on from the premises?**

(Please see sections 1 and 14 of the Licensing Act 2003 and Schedule 1 and 2 to the Licensing Act 2003)

**Provision of regulated entertainment:**

- a) plays (if ticking yes, fill in box A)
- b) films (if ticking yes, fill in box B)
- c) indoor sporting events (if ticking yes, fill in box C)
- d) boxing or wrestling entertainment (if ticking yes, fill in box D)
- e) live music (if ticking yes, fill in box E)
- f) recorded music (if ticking yes, fill in box F)
- g) performances of dance (if ticking yes, fill in box G)
- h) anything of a similar description to that falling within (e), (f) or (g) (if ticking yes, fill in box H)

**Please tick ✓**  
(yes)

☐☐☐☐

x

x

x

x

**Provision of late night refreshment** (if ticking yes, fill in box L)

x

**Sale by retail of alcohol** (if ticking yes, fill in box M)

x

**In all cases complete boxes K, L and M**

## A

<b>Plays</b> Standard days & timings (Please read guidance note 6)			<b>Will the performance of a play take place indoors or outdoors or both – please tick [✓]</b> (Please read guidance note 2).		Indoors	
					Outdoors	
					Both	
Day	Start	Finish	<b>Please give further details here</b> (please read guidance note 3)			
Mon						
Tue						
Wed			<b>State any seasonal variations for performing plays</b> (please read guidance note 4)			
Thurs						
Fri			<b>Non-standard timings. Where you intend to use the premises for the performance of plays at different times to those listed in the column on the left, please list</b> (please read guidance note 5)			
Sat						
Sun						

## B

<b>Films</b> Standard days & timings (Please read guidance note 6)			<b>Will the exhibition of films take place indoors or outdoors or both – please tick [✓]</b> (Please read guidance note 2).		Indoors	
					Outdoors	
					Both	
Day	Start	Finish	<b>Please give further details here</b> (please read guidance note 3)			
Mon						
Tue						
Wed			<b>State any seasonal variations for the exhibition of films</b> (please read guidance note 4)			
Thurs						
Fri			<b>Non-standard timings. Where you intend to use the premises for the exhibition of films at different times to those listed in the column on the left, please list</b> (please read guidance note 5)			
Sat						
Sun						

## C

<b>Indoor sporting events</b> Standard days & timings (Please read guidance note 6)			<b>Please give further details here</b> (please read guidance note 3)
Day	Start	Finish	
Mon			<b>State any seasonal variations for indoor sporting events</b> (please read guidance note 4)
Tue			
Wed			
Thurs			<b>Non-standard timings. Where you intend to use the premises for indoor sporting events at different times to those listed in the column on the left, please list</b> (please read guidance note 5)
Fri			
Sat			
Sun			

## D

<b>Boxing or wrestling entertainment</b> Standard days & timings (Please read guidance note 6)			<b>Will the boxing or wrestling entertainment take place indoors or outdoors or both – please tick [✓]</b> (Please read guidance note 2).	Indoors	
				Outdoors	
				Both	
Day	Start	Finish	<b>Please give further details here</b> (please read guidance note 3)		
Mon			<b>State any seasonal variations for boxing or wrestling entertainment</b> (please read guidance note 4)		
Tue					
Wed					
Thurs			<b>Non-standard timings. Where you intend to use the premises for boxing or wrestling entertainment at different times to those listed in the column on the left, please list</b> (please read guidance note 5)		
Fri					
Sat					
Sun					



# E

<b>Live music</b> Standard days & timings (Please read guidance note 6)			<b>Will the performance of live music take place indoors or outdoors or both</b> – please tick [✓] (Please read guidance note 2).		Indoors	X
					Outdoors	
					Both	
Day	Start	Finish	<b>Please give further details here</b> (please read guidance note 3) Performance by solo artists or groups with or without amplified music will be offered from time to time.			
Mon	1000	0000				
Tue	1000	0000				
Wed	1000	0000	<b>State any seasonal variations for performing of live music</b> (please read guidance note 4)			
Thurs	1000	0000	NEW YEARS EVE UNTIL 0200 THE FOLLOWING MORNING			
Fri	1000	0000	<b>Non-standard timings. Where you intend to use the premises for the performance of live music at different times to those listed in the column on the left, please list</b> (please read guidance note 5)			
Sat	1000	0000	NEW YEARS EVE UNTIL 0200 THE FOLLOWING MORNING			
Sun	1000	0000				

This section is intentionally blank

## F

<b>Recorded music</b> Standard days & timings (Please read guidance note 6)			<b>Will the playing of recorded music take place indoors or outdoors or both – please tick [✓]</b> (Please read guidance note 2).		Indoors	X
					Outdoors	
					Both	
Day	Start	Finish	<b>Please give further details here</b> (please read guidance note 3)			
Mon	1000	0000	Musical entertainment for the enjoyment of the customers including amplified recorded music with or without DJ.			
Tue	1000	0000				
Wed	1000	0000	<b>State any seasonal variations for playing of recorded music</b> (please read guidance note 4)			
			NEW YEARS EVE UNTIL 0200 THE FOLLOWING MORNING			
Thurs	1000	0000				
Fri	1000	0000				
			<b>Non-standard timings. Where you intend to use the premises for the playing of recorded music entertainment at different times to those listed in the column on the left, please list</b> (please read guidance note 5)			
Sat	1000	0000	NEW YEARS EVE UNTIL 0200 THE FOLLOWING MORNING			
Sun	1000	0000				

## G

<b>Performance of dance</b> Standard days & timings (Please read guidance note 6)			<b>Will the performance of dance take place indoors or outdoors or both – please tick [✓]</b> (Please read guidance note 2).		Indoors	X
					Outdoors	
					Both	
Day	Start	Finish	<b>Please give further details here</b> (please read guidance note 3)			
Mon						
Tue						
Wed			<b>State any seasonal variations for performing of dance</b> (please read guidance note 4)			
Thurs						
Fri						
			<b>Non-standard timings. Where you intend to use the premises for the performance of dance entertainment at different times to those listed in the column on the left, please list</b> (please read guidance note 5)			
Sat						
Sun						

## H

<b>Anything of a similar description to that falling within (e), (f) or (g)</b> Standard days & timings (Please read guidance note 6)			Please give a description of the type of entertainment you will be providing		
Day	Start	Finish	<b>Will the this entertainment take place indoors or outdoors or both – please tick [✓]</b> (Please read guidance note 2).	Indoors	X
				Outdoors	
				Both	
Mon	1000	0000	<b>Please give further details here</b> (please read guidance note 3)  All forms of entertainment with or without amplified sound not falling within categories e and f above		
Tue	1000	0000			
Wed	1000	0000			
Thurs	1000	0000	<b>State any seasonal variations for entertainment</b> (please read guidance note 4)  <u>NEW YEARS EVE UNTIL 0200 THE FOLLOWING MORNING</u>		
Fri	1000	0000	<b>Non-standard timings. Where you intend to use the premises for the entertainment of similar description to that falling within (e), (f) or (g) at different times to those listed in the column on the left, please list</b> (please read guidance note 5)  <u>NEW YEARS EVE UNTIL 0200 THE FOLLOWING MORNING</u>		
Sat	1000	0000			
Sun	1000	0000			

This section is intentionally blank

<b>Late night refreshment</b> Standard days and timings (please read guidance note 6)			<b>Will the provision of late night refreshment take place indoors or outdoors or both – please tick [✓] (Please read guidance note 2).</b>		Indoors	
					Outdoors	
					Both	X
Day	Start	Finish				
Mon	2300	0000	<u>Please give further details here</u> (please read guidance note 3)			
Tue	2300	0000				
Wed	2300	0000	<b>State any seasonal variations for the provision of late night refreshment</b> (please read guidance note 4) NEW YEARS EVE UNTIL 0200 THE FOLLOWING MORNING			
Thurs	2300	0000				
Fri	2300	0000	<b>Non-standard timings. Where you intend to use the premises for the provision of late night refreshment at different times to those listed in the column on the left, please list</b> (please read guidance note 5)  NEW YEARS EVE UNTIL 0200 THE FOLLOWING MORNING			
Sat	2300	0000				
Sun	2300	0000				

This section is intentionally blank

# J

<b>Supply of alcohol</b> Standard days and timings (please read guidance note 6)			<b>Will the supply of alcohol be for consumption – please tick [✓] (Please read guidance note 7).</b>	On the premises <input type="checkbox"/>	Off the premises <input type="checkbox"/>	Both <input checked="" type="checkbox"/>
Day	Start	Finish				
Mon	1000	0000	<b><u>State any proposed seasonal variations for the supply of alcohol</u></b> (please read guidance note 4) NEW YEARS EVE UNTIL 0200 THE FOLLOWING MORNING			
Tue	1000	0000				
Wed	1000	0000				
Thurs	1000	0000	<b><u>State any seasonal variations for the provision of facilities for entertainment of a similar description to that falling within J or K</u></b> (please read guidance note 5)			
Fri	1000	0000				
Sat	1000	0000	<b><u>Non-standard timings. Where you intend to use the premises for the supply of alcohol at different times to those listed in the column on the left, please list (please read guidance note 10)</u></b>			
Sun	1000	0000	NEW YEARS EVE UNTIL 0200 THE FOLLOWING MORNING			

<b>State the name and details of the individual whom you wish to specify on the licence as premises supervisor</b>	
Name	SCOTT REILLY
Address	<div style="background-color: black; width: 100px; height: 1.2em;"></div>
Postcode	
Personal Licence Number (if known)	LN000000963.....
Issuing Licensing Authority (if known)	WEST LANCASHIRE BOROUGH COUNCIL.....

## K

**Please highlight any adult entertainment or services, activities, other entertainment or matters ancillary to the use of the premises that may give rise to concern in respect of children (please read guidance note 8)**

None

## L

<b>Hours premises are open to the public</b> Standard days and timings (please read guidance note 6)			<b>State any seasonal variations</b> (Please read guidance note 4).	
Day	Start	Finish	NEW YEARS EVE UNTIL 0230 THE FOLLOWING MORNING	
Mon	1000	0030		
Tue	1000	0030		
Wed	1000	0030		
Thurs	1000	0030		<b>Non-standard timings. Where you intend to use the premises to be open to the public at different times from those listed in the column on the left, please list (please read guidance note 5)</b>  NEW YEARS EVE UNTIL 0230 THE FOLLOWING MORNING
Fri	1000	0030		
Sat	1000	0030		
Sun	1000	0030		

## M

Describe the steps you intend to take to promote the four licensing objectives:

**a) General – all four licensing objectives (b, c, d, e) (please read guidance note 9)**

No supply of alcohol may be made under the Premises Licence:-

a) At a time when there is no Designated Premises Supervisor in respect of the premises licence, or

b) At a time when the Designated Premises Supervisor does not hold a personal licence or his personal licence is suspended.

Every supply of alcohol under the premises licence must be made or authorised by a person who holds a personal licence. The responsible person must ensure that staff on relevant premises do not carry out, arrange or participate in any irresponsible promotions in relation to the premises. (2) In this paragraph, an irresponsible promotion means any one or more of the following activities, or substantially similar activities, carried on for the purpose of encouraging the sale or supply of alcohol for consumption on the premises— (a) games or other activities which require or encourage, or are designed to require or encourage, individuals to— (i) drink a quantity of alcohol within a time limit (other than to drink alcohol sold or supplied on the premises before the cessation of the period in which the responsible person is authorised to sell or supply alcohol), or (ii) drink as much alcohol as possible (whether within a time limit or otherwise); (b) provision of unlimited or unspecified quantities of alcohol free or for a fixed or discounted fee to the public or to a group defined by a particular characteristic in a manner which carries a significant risk of undermining a licensing objective; (c) provision of free or discounted alcohol or any other thing as a prize to encourage or reward the purchase and consumption of alcohol over a period of 24 hours or less in a manner which carries a significant risk of undermining a licensing objective; (d) selling or supplying alcohol in association with promotional posters or flyers on, or in the vicinity of, the premises which can reasonably be considered to condone, encourage or glamorise anti-social behaviour or to refer to the effects of drunkenness in any favourable manner; (e) dispensing alcohol directly by one person into the mouth of another (other than where that other person is unable to drink without assistance by reason of disability). The responsible person must ensure that free potable water is provided on request to customers where it is reasonably available. "

Quiet departure notices shall be on display.

A taxi booking policy shall be in place.

There shall be a knock back policy in place and all staff shall be appropriately trained in knock back procedure.

CCTV shall be provided in the form of a recordable system capable of providing pictures of evidential quality and in all lighting conditions particularly facial recognition. Cameras shall encompass all ingress and egress to the premises and all areas where the sale/supply of alcohol occurs. Equipment shall be maintained in good working order and correctly time and date stamped, recordings shall be kept in date order, numbered sequentially and kept for a period of thirty-one days and handed to the Police on request. The recording equipment and tapes/discs shall be kept in a secured environment under the control of the Premises Licence Holder or other responsible named individual.

There shall be a drugs policy in place and appropriate signage displayed. Noise shall be

limited after midnight 00.00 hours. Live music shall be finished by the hours specified. Recorded music shall be turned down and changed to wind down music one hour before closing. Regulated entertainment is to be held internally only and no music or speakers shall be provided to the external areas of the premises. The DPS or duty manager shall take all reasonable steps to prevent annoyance or nuisance point persons leaving the premises and shall provide suitable notices at each egress point. Such notices shall be protected from damage or deterioration.

The premises licence holder or club premises certificate holder must ensure that an age verification policy is adopted in respect of the premises in relation to the sale or supply of alcohol. (2) The designated premises supervisor in relation to the premises licence must ensure that the supply of alcohol at the premises is carried on in accordance with the age verification policy. (3) The policy must require individuals who appear to the responsible person to be under 18 years of age (or such older age as may be specified in the policy) to produce on request, before being served alcohol, identification bearing their photograph, date of birth and either— (a) a holographic mark, or (b) an ultraviolet feature. The responsible person must ensure that— (a) where any of the following alcoholic drinks is sold or supplied for consumption on the premises (other than alcoholic drinks sold or supplied having been made up in advance ready for sale or supply in a securely closed container) it is available to customers in the following measures— (i) beer or cider: ½ pint; (ii) gin, rum, vodka or whisky: 25 ml or 35 ml; and (iii) still wine in a glass: 125 ml; (b) these measures are displayed in a menu, price list or other printed material which is available to customers on the premises; and (c) where a customer does not in relation to a sale of alcohol specify the quantity of alcohol to be sold, the customer is made aware that these measures are available. "

A relevant person shall ensure that no alcohol is sold or supplied for consumption on or off the premises for a price which is less than the permitted price. 2. For the purposes of the condition set out in paragraph 1 - (a) "duty" is to be construed in accordance with the Alcoholic Liquor Duties Act 1979; (b) "permitted price" is the price found by applying the formula  $P = D + (D \times V)$ , where - (i) P is the permitted price, (ii) D is the rate of duty chargeable in relation to the alcohol as if the duty were charged on the date of the sale or supply of the alcohol, and (iii) V is the rate of value added tax chargeable in relation to the alcohol as if the value added tax were charged on the date of the sale or supply of the alcohol; (c) "relevant person" means, in relation to premises in respect of which there is in force a premises licence - (i) the holder of the premises licence, (ii) the designated premises supervisor (if any) in respect of such a licence, or (iii) the personal licence holder who makes or authorises a supply of alcohol under such a licence; (d) "relevant person" means, in relation to premises in respect of which there is in force a club premises certificate, any member or officer of the club present on the premises in a capacity which enables the member or officer to prevent the supply in question; and (e) "value added tax" means value added tax charged in accordance with the Value Added Tax Act 1994. 3. Where the permitted price given by Paragraph (b) of paragraph 2 would (apart from this paragraph) not be a whole number of pennies, the price given by that sub-paragraph shall be taken to be the price actually given by that sub-paragraph rounded up to the nearest penny. 4. 1) Sub-paragraph (2) applies where the permitted price given by Paragraph (b) of paragraph 2 on a day ("the first day") would be different from the permitted price on the next day ("the second day") as a result of a change to the rate of duty or value added tax. (2) The permitted price which would apply on the first day applies to sales or supplies of alcohol which take place before the expiry of the period of 14 days beginning on the second day.



**b) The prevention of crime and disorder**

See (a) above

**c) Public safety**

See (a) above

**d) The prevention of public nuisance**

See (a) above

**e) The protection of children from harm**

See (a) above

	<u>Please tick</u> ✓ (yes)
- I have made or enclosed payment of the fee	x
- I have enclosed a plan of the premises	x
- I have sent copies of this application and the plan to responsible authorities and others where applicable	x
- I have enclosed the consent form completed by the individual I wish to be premises supervisor, if applicable.	x
- I understand that I must now advertise my application.	x
- I understand that if I do not comply with the above requirements my application will be rejected	x

**IT IS AN OFFENCE, LIABLE ON CONVICTION TO A FINE UP TO LEVEL 5 ON THE STANDARD SCALE, UNDER SECTION 158 OF THE LICENSING ACT 2003 TO MAKE A FALSE STATEMENT IN OR IN CONNECTION WITH THIS APPLICATION**

**Part 4 – Signatures** (please read guidance note 10)

**Signature of applicant or applicant's solicitor or other duly authorised agent.** (Please read guidance note 11). **If signing on behalf of the applicant please state in what capacity.**

Signature: .....

Date: .....

Capacity: Applicants Solicitor

**Terry McGraw LLB**  
**Solicitor**  
**Whitfields Solicitors**  
**Marion House, 23/25 Elbow Lane**  
**Formby, Liverpool L37 4AB**

**For joint applications signature of 2<sup>nd</sup> applicant or 2<sup>nd</sup> applicant's solicitor or other authorised agent.** (Please read guidance note 12). **If signing on behalf of the applicant please state in what capacity.**

Signature: .....

Date: .....

Capacity: .....

<b>Contact name (where not previously given) and address for correspondence associated with this application</b> (please read guidance note 13) Terry McGraw Whitfields Solicitors Limited 23/25 Elbow Lane Formby	
<b>Post town</b> Liverpool	<b>Post code</b> L37 4AB
<b>Telephone number</b> 01704 878501	
<b>If you would prefer us to correspond with you by e-mail your e-mail address (optional)</b> terry@whitfieldssolicitors.com	

**Notes for Guidance**

1. Describe the premises. For example the type of premises, its general situation and layout and any other information which could be relevant to the licensing objectives. Where your application includes off-supplies of alcohol and you intend to provide a place for consumption of these off-supplies you must include a description of where the place will be and its proximity to the premises.
2. Where taking place in a building or other structure please tick as appropriate. Indoors may include a tent.
3. For example the type of activity to be authorised, if not already stated, and give relevant further details, for example (but not exclusively) whether or not music will be amplified or unamplified.
4. For example (but not exclusively), where the activity will occur on additional days during the summer months.

5. For example (but not exclusively), where you wish the activity to go on longer on a particular day i.e. Christmas Eve.
6. Please give timings in 24 hour clock (e.g.16:00) and only give details for the days of the week when you intend the premises to be used for the activity.
7. If you wish people to be able to consume alcohol on the premises please tick on, if you wish people to be able to purchase alcohol to consume away from the premises please tick off. If you wish people to be able to do both please tick both.
8. Please give information about anything intended to occur at the premises or ancillary to the use of the premises which may give rise to concern in respect of children, regardless of whether you intend children to have access to the premises, for example (but not exclusively) nudity or semi-nudity, films for restricted age groups, the presence of gaming machines.
9. Please list here steps you will take to promote all four licensing objectives together.
10. The application form must be signed.
11. A applicant's agent (for example solicitor) may sign the form on their behalf provided that they have actual authority to do so.
12. Where there is more than one applicant, both applicants or their respective agents must sign the application form.
13. This is the address which we shall use to correspond with you about this application.



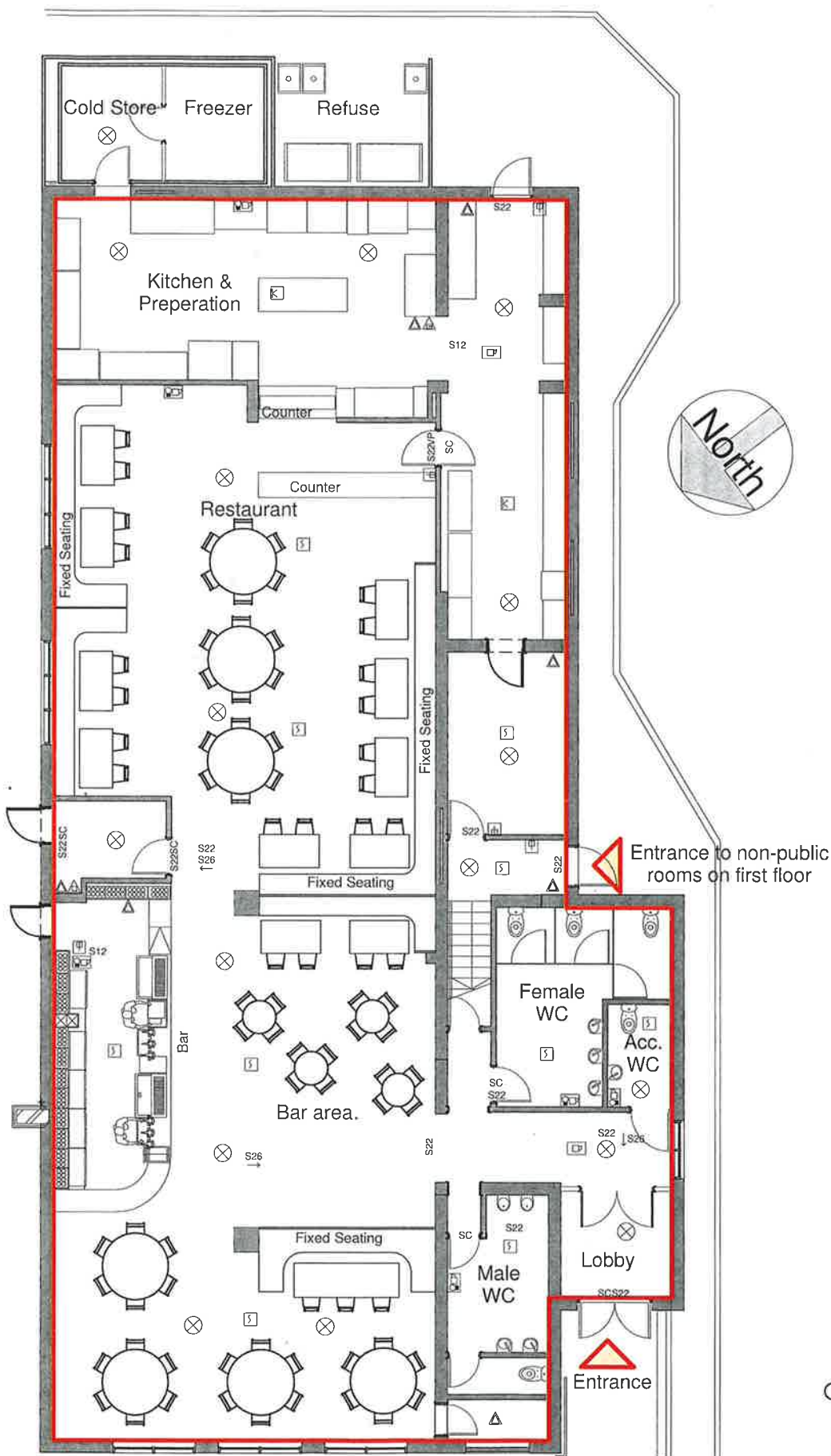

#### Fire Fighting Equipment

- Portable Free Standing Water (Fire Extinguisher)
- Portable Free Standing Foam (Fire Extinguisher)
- Dry Powder (Fire Extinguisher)
- Any type Gas (Fire Extinguisher)
- Halon Gas (Fire Extinguisher)
- Carbon Dioxide (Fire Extinguisher)
- Water Bucket
- BC Dry Powder (Fire Extinguisher)
- ABC Dry Powder (Fire Extinguisher)
- Sand Bucket
- Fire Blanket
- Fire Point
- Hosereel

#### Control and Indicating Equipment

- Sounder
- Illuminated Signal
- Control Panel Sounders
- Control Panel Illuminated Signals
- Control Panel Sounders and Illuminated Signals

#### Control and Indicating Equipment

- Heat Detector
- Smoke Detector
- Flame Detector
- Gas Detector
- Fire Alarm Manual Call Point

#### Building Elements

- VP Vision Panel
- SC Self Closing
- PB Push Bar Ironmongery
- Stairway, Arrow indicates up direction
- Ramp, Arrow indicates up direction
- Emergency Escape Light In Accordance with BS5266:Part1

#### Fire Safety Signs

- S2 Smoking is Prohibited
- S8 Flammable Materials
- S22 Fire Exit
- S26 Directional Arrow
- S12 Fire Action Sign

## Ground Floor Plan (A3)

1 : 100

Client:

Ormskirk Pubco Ltd.

Site Location:

188 Moss Lane  
Ormskirk  
L40 4AY

